

ALI S. SHEIKH ABDILAH I - SUITE #75

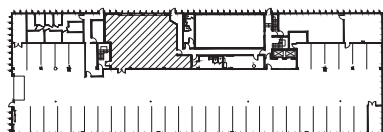

NOTE:
BUILDING PLANS AND
SQUARE FOOTAGE HAVE
NOT BEEN FIELD VERIFIED

VALLEY OFFICE PARK

10800 LYNDAL E AVE

LOWER LEVEL

BLOOMINGTON, MN 55420

07/26/23

2,066 RSF